



घर हो तो कुछ different  
घर हो तो  
ORGANIC

ORGANIC HOMES

# SITE PLAN

OWN A PART OF IT TO LIVE THE WHOLE

AMENITIES

- |                          |   |                     |
|--------------------------|---|---------------------|
| 1. HALF BASKETBALL COURT | ↑ | 9. PARTY LAWN       |
| 2. BADMINTON COURT       |   | 10. AMPHITHEATER    |
| 3. CHILDREN'S PLAY AREA  |   | 11. MEDITATION      |
| 4. WATER FOUNTAIN        |   | 12. YOGA LAWN       |
| 5. SAND PIT              |   | 13. FLOWER BED      |
| 6. MAZE                  |   | 14. SHOPPING STREET |
| 7. CHILDREN'S POOL       |   | 15. NATUROTHERAPY   |
| 8. CLUB                  | ↓ | 16. JOGGING TRACK   |



# FLOOR PLAN

2 Bedrooms + 2 Toilets (1040 sq.ft.)



2 Bedrooms + 2 Toilets + Study (1239 sq.ft.)



3 Bedrooms + 2 Toilets (1496 sq.ft.)  
(Type - 1)



3 Bedrooms + 2 Toilets (1496 sq.ft.)  
(Type - 2)



3 Bedrooms + 3 Toilets + Study (1733 sq.ft.)  
(Type - 1)

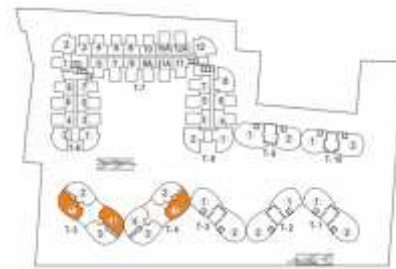

3 Bedrooms + 3 Toilets + Study (1733 sq.ft.)  
(Type - 2)

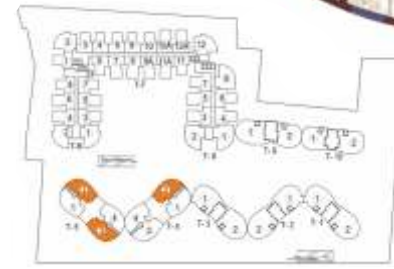

3 Bedrooms + 3 Toilets + Pvt. Lift (1733 sq.ft.)  
(Type - 1)



3 Bedrooms + 3 Toilets + Pvt. Lift (1733 sq.ft.)  
(Type - 2)



**4 Bedrooms + 3 Toilets Units (2095 sq.ft.)**  
(Type - 1)

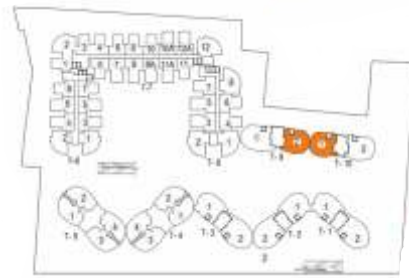

**4 Bedrooms + 3 Toilets Units (2095 sq.ft.)**  
(Type - 2)

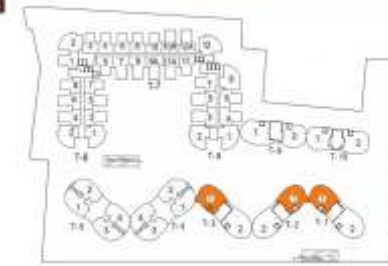

4 Bedrooms + 4 Toilets Units (2415 sq.ft.)  
(Type - 1)



4 Bedrooms + 4 Toilets Units (2415 sq.ft.)  
(Type - 2)

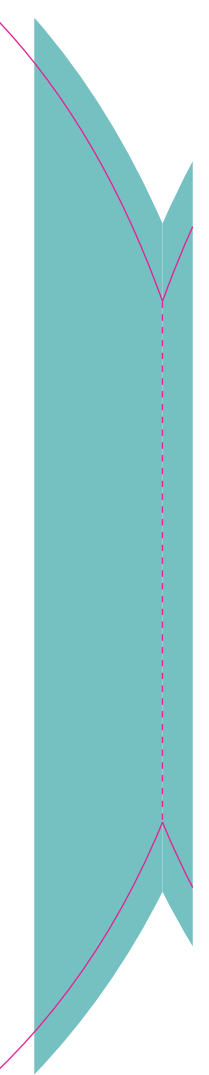

INFINITY POOL AT TERRACE FLOOR



NIGHT VIEW



DAY VIEW



## AMENITIES AT TERRACE FLOOR



PARTY AREA



REFLEXOLOGY /ZEN GARDEN





SKY BAR



KIDS PLAY AREA

# SPECIFICATIONS



**STRUCTURE**  
Earthquake Resistant RCC Framed



**LIVING ROOM**  
**Floor** - Vitrified Tiles | **External Door and Window** - Powder Coated Aluminium/UPVC | **Walls** - Oil Bound Distemper | **Internal Door** - Flush Shutter with Hard Wood Frame | **Electrical** - Copper Wiring and PVC Concealed conduit, Provision for adequate light and power points as well as TV outlets with modular switches | **Ceilings** - Oil Bound Distemper Over Designer POP.



**TOILET**  
**Floor** - Anti Skid Ceramic Tiles | **Walls** - Ceramic Tiles of upto 7' height | **Fittings** - Washbasin WC & C.P. Fittings | **Internal Door** - Flush Shutter with Hard Wood Frames | **Electrical**- Copper Wiring and PVC Concealed conduit, Provision for adequate light and power points with modular switches | **Water Supply** - 24 Hours Water Supply & Separate Lines for Hot & Cold Water.



**BEDROOM**  
**Floor** - Vitrified Tiles | **External Doors & Windows** - Powder Coated Aluminium/UPVC | **Walls** - Oil Bound Distemper | **Internal Doors** - Flush Shutters with Hard Wood Frame | **Electrical** - Copper Wiring and PVC Concealed conduit, Provision for adequate light and power points as well as TV outlets with modular switches | **Ceilings** - Oil Bound Distemper over Designer POP.



**BALCONIES**  
**Floor** - Anti-Skid Ceramic Tiles/Terazzo Tiles | **Walls** - Oil Bound Distemper | **Electrical** - Copper Wiring and PVC Concealed conduit, Provision for adequate light and power points with Modular Switches | **Ceilings** - Oil Bound Distemper.





#### MASTER BEDROOM

**Floor** - Laminated Wooden Flooring | **External Doors & Windows** - Powder Coated Aluminium/UPVC | **Walls** - Oil Bound Distemper | **Internal Doors** - Flush Shutter with Hard Wood Frame | **Electrical** - Copper Wiring and PVC Concealed conduit, Provision for adequate light and power points as well as TV outlets with modular switches | **Ceilings** - Oil Bound Distemper over Designer POP.



#### LOBBIES/CORRIDOR

**Floors** - Kota Stone/Vitrified Tiles | **Walls** - Oil Bound Distemper | **Electrical** - Copper Wiring and PVC Concealed conduit



#### ELEVATORS

High Speed Elevator

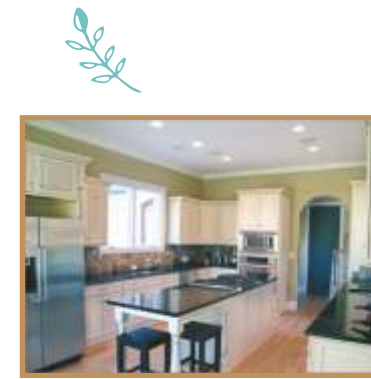

#### KITCHEN

**Floor** - Combination of Anti-Skid Ceramic Tiles/Vitrified Tiles | **External Doors & Windows** - Powder Coated Aluminium/UPVC | **Walls** - Ceramic Tiles of 2' height from the platform | **Fittings** - Stainless steel sink with C.P. Fittings | **Electrical** - Copper Wiring and PVC Concealed conduit, Provision for adequate light and power points with Modular Switches | **Water Supply** - 24 hours water supply with Separate Lines for Hot & Cold Water | **Ceilings** - Oil Bound Distemper | **Counter** - Granite Working Platform



#### ELECTRICAL

24 Hours Power Backup

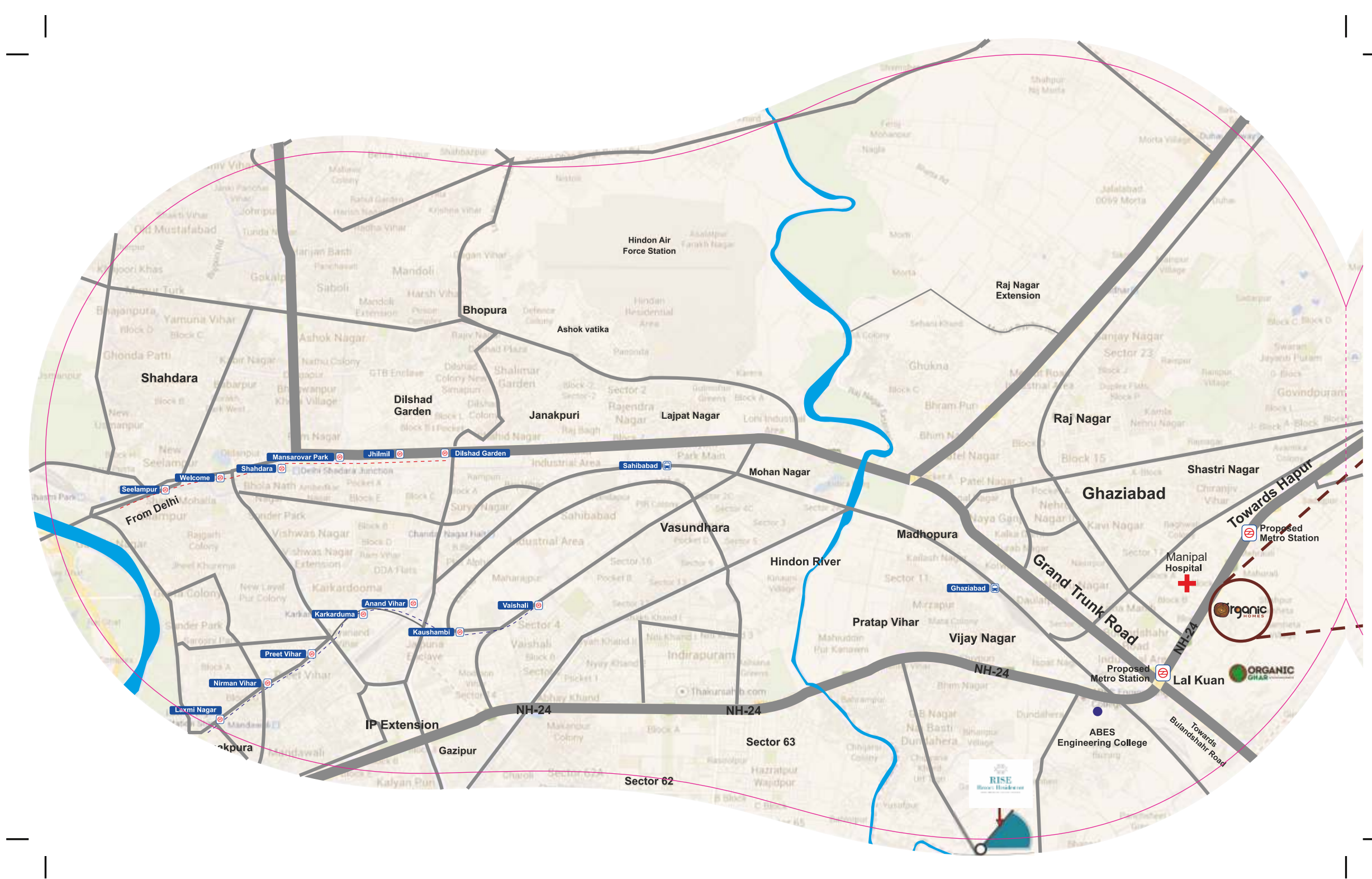

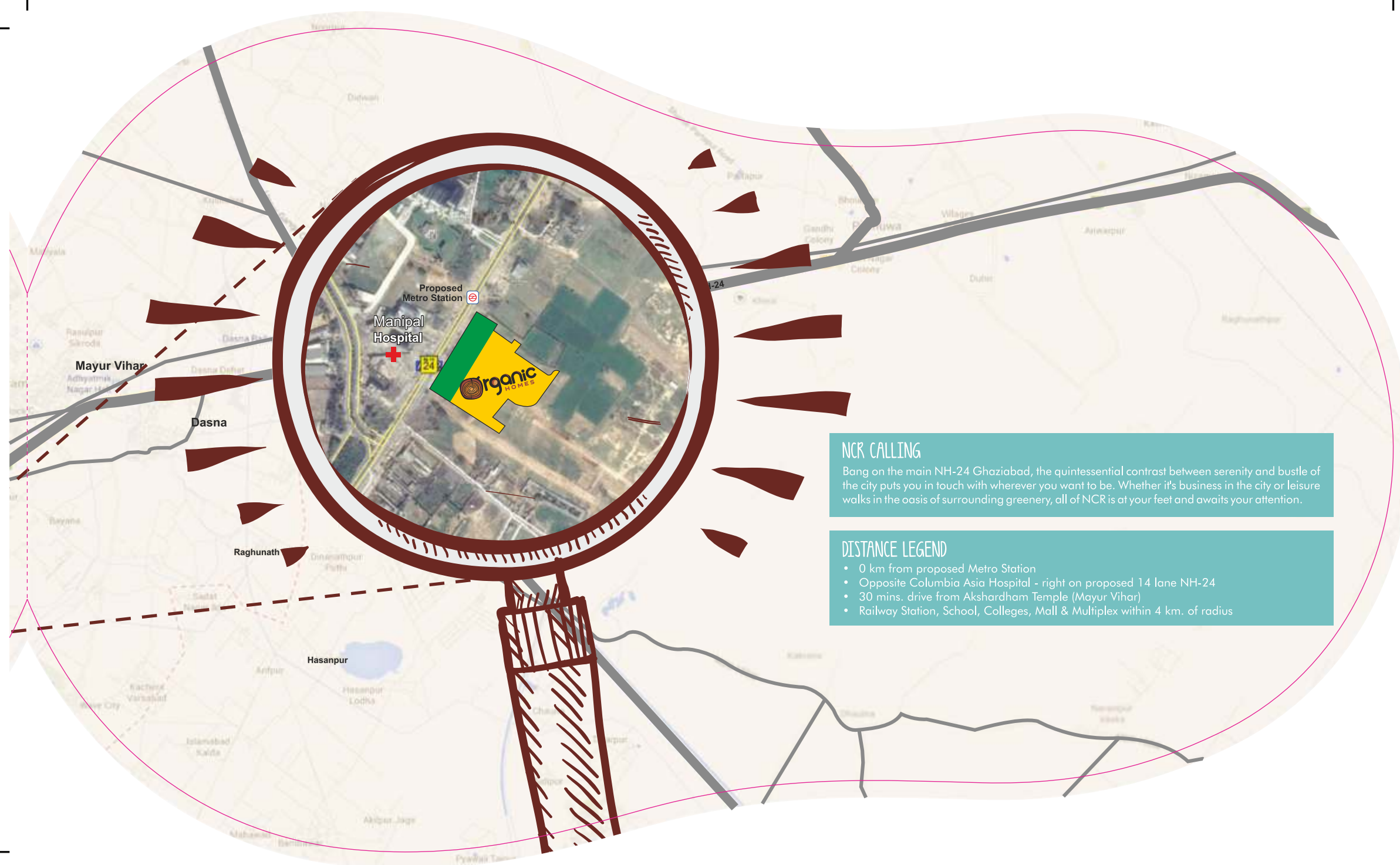

**NCR CALLING**  
Bang on the main NH-24 Ghaziabad, the quintessential contrast between serenity and bustle of the city puts you in touch with wherever you want to be. Whether it's business in the city or leisure walks in the oasis of surrounding greenery, all of NCR is at your feet and awaits your attention.

- DISTANCE LEGEND**
- 0 km from proposed Metro Station
  - Opposite Columbia Asia Hospital - right on proposed 14 lane NH-24
  - 30 mins. drive from Akshardham Temple (Mayur Vihar)
  - Railway Station, School, Colleges, Mall & Multiplex within 4 km. of radius



**Site Address:**  
GH-01, Jaipuria Sunrise Greens,  
Opposite Manipal Hospital, NH-24, Ghaziabad.

**Regd Office:**  
195 ,(Basement ) Ram Vihar , Delhi -110092

\* All images are artistic impression and do not constitute legal offering.